

Wiscon 12 Pocket Program

| | Friday | Saturday | Sunday |
|--------------|------------------------------------|----------------------------|-----------------------------|
| Registration | Noon - 8 PM | 9 AM - 3 PM | 10 AM - Noon (WisCon 13) |
| Art Show | 10AM - 3PM (setup) 3 PM - 6 PM | 10 AM - 6 PM | 10 AM - Noon (Pickup) |
| Huxter Room | Noon - 2 PM (setup) 2 PM - 6 PM | 10 AM - 6 PM | 10 AM - 3 PM |
| Con Suite | 8 PM - 3 AM | Noon - 6 PM 8 PM - 4 AM | 11 AM - 5 PM |

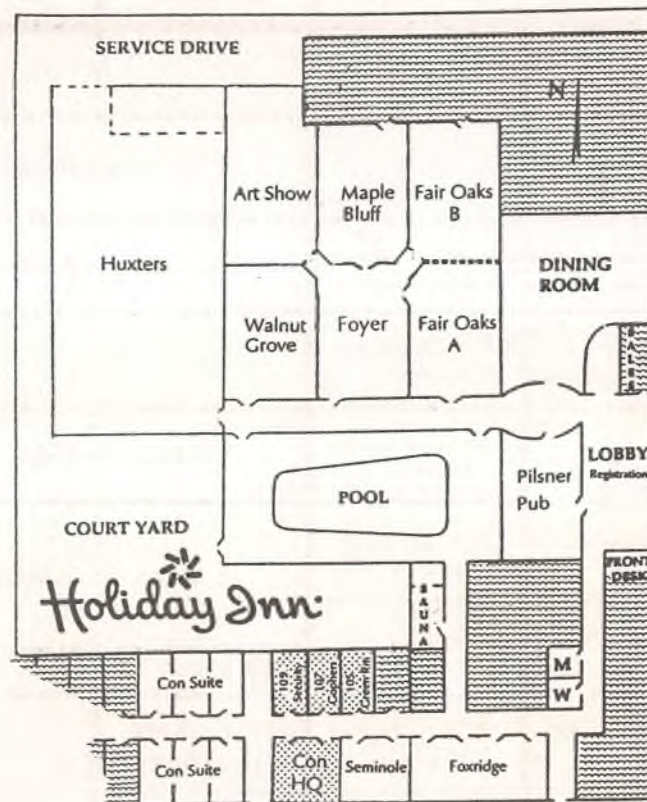

The Green Room is open for program participants one half hour before any program block begins, and closes when the last program of the block ends.

| Friday 8:00 PM | Walnut Grove | Maple Bluff | Fair Oaks A | Fair Oaks B | Foxridge | Seminole | Pilsner Pub | Pool Terrace | Friday 8:00 PM |
|-------------------|--------------|---------------------------|-------------|-----------------------------|--------------------------------|--|-------------|--------------|-------------------|
| 9:00 PM | MIXER | MOVIES 8:00 PM COMA | FILK | Silent Films Mrs. Byrnes | 59 Huxter Panel | MEDIA 8:00 PM DAY THE EARTH STOOD STILL | READINGS | OPEN GAMING | 9:00 PM |
| 10:00 PM | | 10:00 PM THE POINT | | & Other Games | 42 Dada, Surrealism & SF | 9:35 PM NIGHT OF THE LIVING DEAD | | | 10:00 PM |
| 11:00 PM | | 11:30 PM ENEMY MINE | | | 30 Midnight Vampire Panel | 11:10 PM LITTLE SHOP OF HORRORS (Orig.) | | | 11:00 PM |
| MIDNIGHT | | | | | | 12:25 PM YOUNG SHERLOCK HOLMES | | | MIDNIGHT |
| 1:00 AM | | 1:25 AM LABYRINTH | | | | Videos by Request | | | 1:00 AM |
| 2:00 AM | | | | | | | | | 2:00 AM |
| 3:00 AM | | | | | | | | | 3:00 AM |
| 4:00 AM | Walnut Grove | Maple Bluff | Fair Oaks A | Fair Oaks B | Foxridge | Seminole | Pilsner Pub | Pool Terrace | 4:00 AM |

| Saturday | Walnut Grove | Maple Bluff | Fair Oaks A | Fair Oaks B | Foxridge | Seminole | Pilsner Pub | Pool Terrace | Saturday |
|----------|---------------------------------|-----------------------------|-----------------------------|-------------|-----------------------------|----------------------------|---------------------|--------------|----------|
| 9:00 AM | | | | | | | | | 9:00 AM |
| 10:00 AM | 16 Women in SF Films ♀ | | 21 Horror and SF # | | 7 Costuming for Larger Fan | 25 Kids Look at Kid's SF/F | READINGS | OPEN GAMING | 10:00 AM |
| 11:00 AM | 20 Homosexuality in SF/F ♀ | 26 Lovecraft as a Modernist | 4 Classics of Alt. Hist. # | | 23 I Still Want to Go | 50 Works of P.K. Dick | ↓ | | 11:00 AM |
| NOON | 13 Fantasy and the Feminine # ♀ | 54 Sex & Shape Changers ♀ | | | | 58 Religious Themes in SF | 12 Fanorama Two (A) | | NOON |
| 1:00 PM | 34 Women in Science ♀ | 8 Mad Victorian Fantasies | 32 Music in a Future Key # | | 14 Fantasy Role-playing | | READINGS | | 1:00 PM |
| 2:00 PM | | 17 Future Hist: How & Why | 5 Computers & Writers | | 1 Artist's Jam # | | ↓ | | 2:00 PM |
| 3:00 PM | 52 Writing About Women # ♀ | 35 SF & Artificial Intel. | | | 48 Women Who Write Horror ♀ | 24 Tiptree Retrospective ♀ | ↓ | | 3:00 PM |
| 4:00 PM | 28 A Handmaid's Tale ♀ | 19 The Graphic Novel # | 44 P. Anthony-Master/Menace | | | 53 Delany's Neveryon ♀ | ↓ | | 4:00 PM |
| 5:00 PM | 43 Trashing Books by Women ♀ | | | | 27 Lowbrow Film Gems | | ↓ | | 5:00 PM |
| 6:00 PM | | | | | | | ↓ | | 6:00 PM |

| Sunday 9:00 AM | Walnut Grove | Maple Bluff | Fair Oaks A | Fair Oaks B | Foxridge | Seminole | Pilsner Pub | Pool Terrace | Sunday 9:00 AM |
|----------------|------------------------------|-------------------------|-------------------------|-------------------------------|--------------------------|--------------------------------|-------------|--------------|----------------|
| 10:00 AM | 41 Tanith Lee ♀ | 9 SF Films of 1987 | Aerobics | 36 Scientists Writing SF | | WisCon 12 Videos | READINGS | OPEN GAMING | 10:00 AM |
| 11:00 AM | 45 Positive Views of Women ♀ | | 38 Sexuality in Fantasy | 39 Shared World Anthologies # | 33 Novels of Pleistocene | MACAVOY READING (Pre-recorded) | ↓ | ↓ | 11:00 AM |
| NOON | 49 Unknown Women Writers ♀ | 55 Genesis of Cyberpunk | | 31 Minnesotans Write SF/F | 51 3 Men & a Worldcon | Mystery Film! | ↓ | ↓ | NOON |
| 1:00 PM | | | | | | | | | 1:00 PM |
| 2:00 PM | | | | | 47 WisCon Wrap-up | WisCon 12 Videos | | | 2:00 PM |
| 3:00 PM | | | | | | | | | 3:00 PM |
| 4:00 PM | | | | | | | | | 4:00 PM |
| 5:00 PM | | | | | | | | | 5:00 PM |
| Sunday | Walnut Grove | Maple Bluff | Fair Oaks A | Fair Oaks B | Foxridge | Seminole | Pilsner Pub | Pool Terrace | Sunday |

Use item numbers to locate descriptions in the program book.

GOH Function

♀ Feminist